

# DL101 Lavatory Faucet Installation Instructions

# DL101

- If mounting through a countertop the three holes needed should be 1¼" to 1⅜" maximum in diameter.
- Maximum deck thickness is 1½".
- Hole spread is adjustable from 8" minimum to 13" maximum.
- A few simple tools will make the installation easier: Basin wrench, small crescent wrench, pliers and Teflon tape.
- Read entire instructions before installing

**Step 1-** Install spout assembly **D1-SA** through the center hole in the sink making sure that the spout base ring **D1-SN** and the black seal washer **D1-ESCW** is in place between the spout base **D1-SB** and the countertop, with the mounting stud **D1-STUD** in the front of the spout. (There is no need to use a sealant underneath the spout base ring **D1-SN** and the two escutcheons **D1-ESC**, as the three seal washers **D1-ESCW** make a watertight seal against the countertop or sink).

➤ **Note:** It may be necessary to put one of the ½" female ends of the supply lines **D1-SUP** through the center hole, one at a time as they both may not fit through together.

**Step 2-** Slide the black collar seal washer **D1-COLW** over the mounting stud **D1-STUD** and then the metal collar **D1-COL**, start mounting the lock nut **D1-NUT** on the bottom of the mounting stud (make sure that open end of collar seal washer and metal collar have the open end facing towards the back wall, away from the sink, as this is where the pop-up rod will go through). Screw the mounting nut **D1-NUT** all the way up the mounting stud **D1-STUD** until it is tight against the metal collar washer **D1-COL** and tighten with a wrench.

**Step 3-** Installing the hot and cold-water valves:

- 3A-** Remove the handle assembly off both of the hot and cold valves by unscrewing the handle base **D1-CN** and lift up on lever handle to remove (this new designed handle does not use any mounting or set screws).
- 3B-** Unscrew the flat escutcheon **D1-ESC** and the bottom seal washer **D1-ESCW** off of the threads on the valve body.
- 3C-** Screw the brass valve bottom lock nut **D1-LNUT** about half way down the valve body along with the two washers **D1-WN** and **D1-WG**, this distance will vary depending on the thickness of the sink or counter top.
- 3D-** Push the hot valve "with red markings" up from underneath the sink on the left hole of the sink as you are facing it. Place the black seal washer **D1-ESCW** on the top of the valve and screw the flat escutcheon **D1-ESC** back onto the threads of the valve body on the top of the sink or counter top, as the flat escutcheon **D1-ESC** will be top lock nut.
- 3E-** The correct distance from the "top" of the flat escutcheon **D1-ESC** to the top of the ceramic cartridge **D1-CARTH** is 1 ¼". This will allow for the

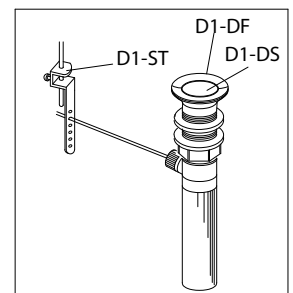
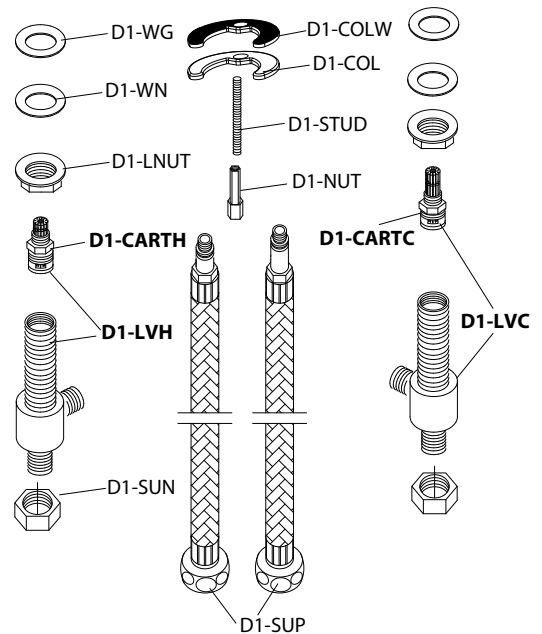
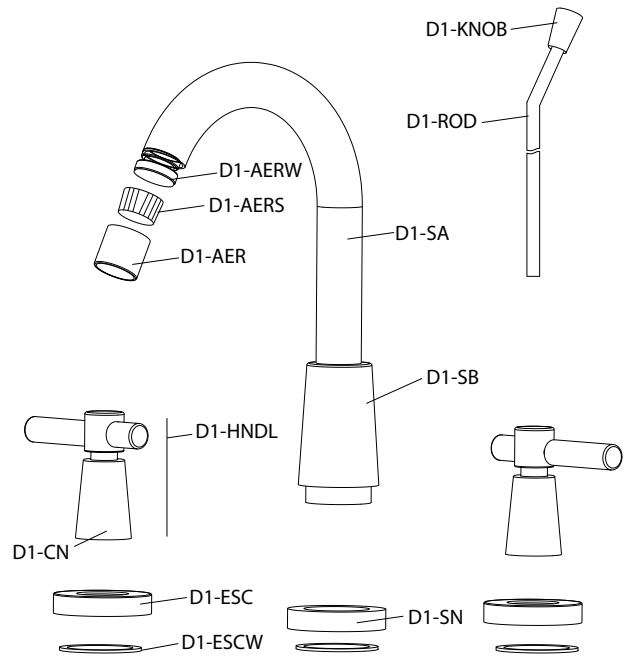

SEE Instructions for Pop Up Assembly

### IMPORTANT CLEANING NOTICE

To maintain your faucet use only mild soap and water

Never use acids, harsh abrasives or detergents

# Giagni

for more information call

888.560.5222 FAX 888.560.8727 Monday - Friday 8:30am to 5:30pm EST

NSF / ANSI 61



DL101

# DL101 Lavatory Faucet Installation Instructions

# DL101

proper height of the handle assembly D1-HNDL.

**3F- Screw the brass lock nut D1-LNUT (make sure that the 1/2" male side outlets on both the valve bodies are pointing inwards towards the center spout as this is where the two supply lines D1-SUP from the spout will attach later) and tighten the brass nut.**

**3G- Repeat the same procedure for the cold valve D1-LVC on the right side of the sink and the handle assembly D1-HNDL.**

**Step 4-** Connect the two female ends of the supply lines **D1-SUP** to the side outlets on the hot and cold valves. Make sure that the hot supply line **D1-SUP** with the "red markings" is attached to the hot valve and the cold supply line with the "blue markings" is attached to the cold valve.

**Step 5-** Install both the handle assemblies **D1-HNDL** back onto the valves by placing them over the ceramic cartridge **D1-CART** and tightening the handle base **D1-CN** onto the threads of the ceramic cartridge.

➤ **Note:** Make sure that both the hot and cold valves are turned to the off position (both should close away from the spout assembly). The angle of the handles when in the off position can be adjusted to suit the home owner but typically the hot handle when in the off position is at 9:00 o'clock and the cold at 3:00 o'clock.

Before tightening the handle base **D1-CN** place the handles in the desired angle and then tighten.

**Step 6-** Pop-up drain: see "Installing pop-up drain assembly"

**Step 7-** Install water supply lines (not supplied) from the shut off valves under the sink to the bottom of the hot and cold valves.

**Step 8-** Remove aerator **D1-AER** from the spout.

**Step 9-** Open both of the hot and cold shut off valves under the sink.

**Step 10-** Turn both the hot and the cold handles on and let the faucet run for about two minutes to flush the lines of any debris that may come from the existing plumbing. If a drip should occur after completion there might be debris inside the ceramic cartridge that is not allowing it to close completely (see bottom note for removal of ceramic cartridges and flush out any debris at another water source).

**Step 11-** Replace Aerator **D1-AER**.

**Step 12-** Turn on both the hot and cold handles again to check all connections under the sink for leaks.

➤ **Note:** If the ceramic cartridges **D1-CARTH** (hot) or **D1-CARTC** (cold) should ever need cleaning or replacing, turn off both of the shut off valves under the sink. Remove the handle assembly **D1-HNDL** by unscrewing the handle base **D1-CN** and then remove the ceramic cartridge with a crescent wrench (not pliers) by unscrewing counter clockwise.

Replace ceramic cartridge and handle assembly in reverse order.

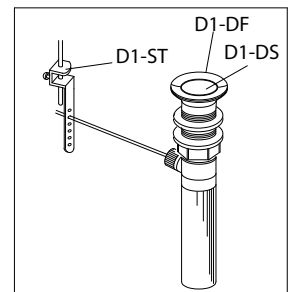
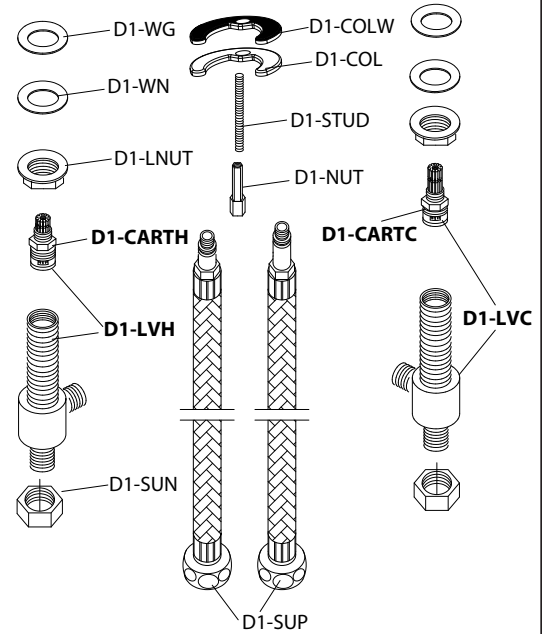
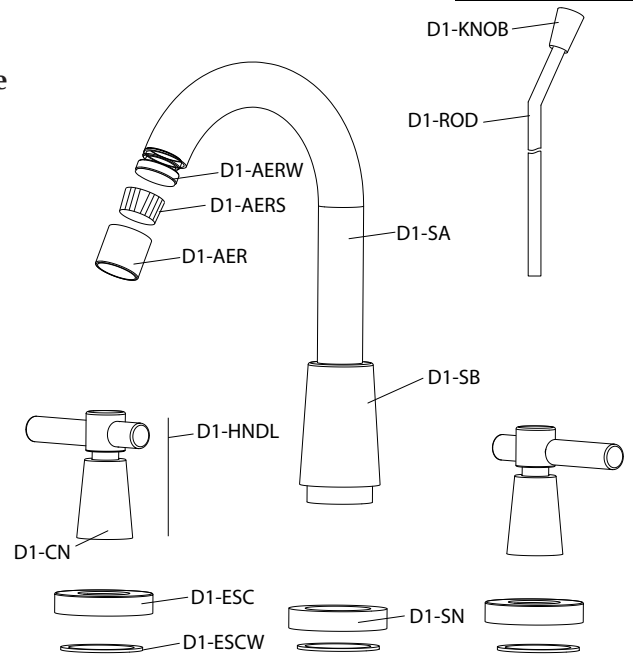

SEE Instructions for Pop Up Assembly

### IMPORTANT CLEANING NOTICE

To maintain your faucet use only mild soap and water

Never use acids, harsh abrasives or detergents

# Giagni

for more information call

888.560.5222 FAX 888.560.8727 Monday - Friday 8:30am to 5:30pm EST

DL101