

HK101 Bridge Kitchen Faucet Installation Instructions

HK101

- Hole diameters are 1 1/8" minimum to 1 1/4" maximum when drilling a counter top.
- This faucet requires 3 holes at 4" on center
- If the side spray is going to be used it requires a 4th hole, see separate side spray instruction sheet for hole diameter drilling dimensions.
- Maximum deck thickness is 1 1/2"
- If optional accessories are going to be added such as a soap dispenser, hot water dispenser, air gap etc. then check with manufacture for the hole diameter requirement.
- This kitchen faucet has been water tested and comes completely assembled (except for the side spray assembly if being used)

•A few simple tools will make the installation easier:

Small crescent wrench, basin wrench, Phillips screwdriver (if removing the handles) and Teflon tape

•Read entire instruction sheet before installing

Step 1- IMPORTANT: Locate the "front" of the faucet before installing, both the hot and the cold handles should point forward when in the open position. With Hot on the left and Cold on the right, as shown here...

1A- If the faucet has already been installed in reverse (rather than having to remove it), shut off both the hot and cold shut off valves under the sink. Remove both the handle assemblies **HK1-07**, by unscrewing the handle caps (do not use pliers as this may damage the finish) **HK1-05** and then removing the handle screws **HK1-06**. Unscrew the handle escutcheons **HK1-08**, then unscrew both the ceramic cartridges, **HK1-09** is the hot side and **HK1-11** is the cold side. Then reverse their position. Replace both the handle assemblies and set to the desired angle according to 1B and 1C below.

1B- The angle of the handles when in the "off" position can be changed by removing the handle cap **HK1-05**, the handle screw **HK1-06** and then pull up on the handle assembly **HK1-07** to remove.

1C- Moving the handle one "notch at a time" on the broach of the ceramic cartridge **HK1-09** will change the angle of the handle. When the desired angle is obtained, replace the handle screw, tighten and then replace the handle cap.

Step 2- Place the three seal washers **HK1-14** inside the groove in the

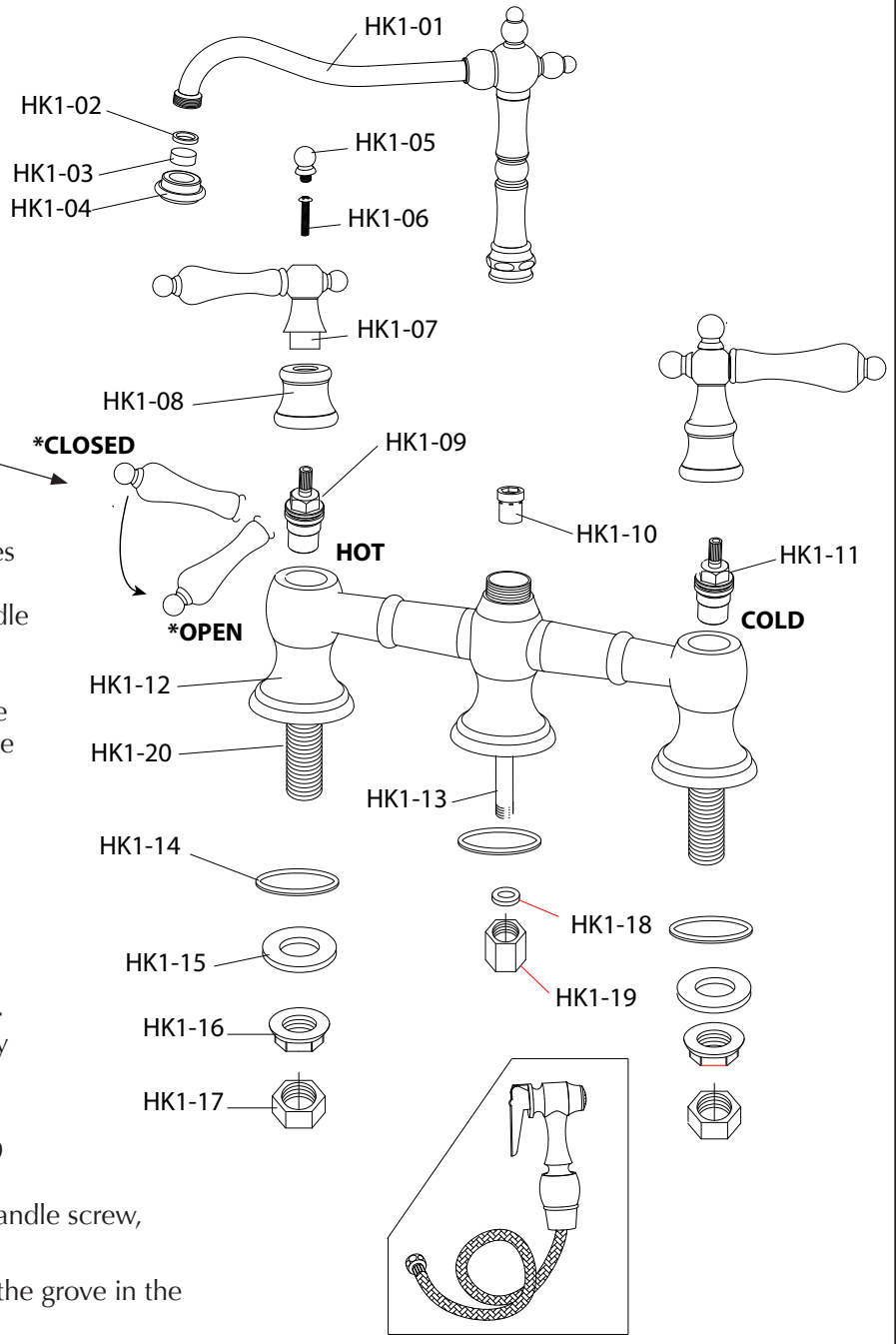

IMPORTANT CLEANING NOTICE

To maintain your faucet use only mild soap and water

Never use acids, harsh abrasives or detergents

Giagni

for more information call

888.560.5222 FAX 888.560.8727 Monday - Friday 8:30am to 5:30pm EST



HK101

HK101 Bridge Kitchen Faucet Installation Instructions

HK101

bottom of each of the three bases on the faucet body, then insert the faucet through the holes in the sink or counter top.

Note: There is no need to use plumbers putty or a sealant between the faucet body and the sink or counter top as the three seal washers **HK1-14** make a watertight seal.

Step 3- Push washer **HK1-15** on one side of the faucet threaded supply tube **HK1-20** then the lock nut **HK1-16** and hand tighten against the bottom of the sink or counter top. Repeat the same procedure on the other threaded supply tube.

Step 4- Make sure that the faucet body **HK1-12** is aligned parallel to the sink back splash or back of sink edge and then tighten both the lock nuts **B1-16** with a wrench.

Step 5- Side spray installation: See separate side spray installation sheet (if not using the side spray, install washer **HK1-18** and brass cap **HK1-19** (packed separately in plastic bag) onto the side spray outlet tube **HK1-13** and tighten.

Step 6- Connect water supply lines (not supplied) from the shut off valves under the sink to the bottom of the hot and cold threaded supply tubes **HK1-20**.

Step 7- Remove the aerator **HK1-04** (by hand, never use a wrench on this aerator as the decorative finish may be damaged).

Step 8- Open both the shut off valves under the sink.

Step 9- Turn both the hot and cold handles on for about two minutes to flush any debris that may have passed through from the existing plumbing. If debris is left in the ceramic cartridges it can damage them or cause them to leak.

9A- When the side spray is being used, depress the handle on side spray **SPT** while the faucet is running to flush the internal diverter and side spray assembly.

If debris should be clogged inside the side spray, unscrew the side spray tip **SPT**, rinse the backside to clear holes, then replace.

Step 10- Replace the aerator **HK1-04** on the end of the spout by hand.

Step 11- Turn the faucet on and check all connections under the sink for leaks.

➤ Clean all decorative faucet trim with a mild soap and water then dry with a soft cotton cloth.

Note: If the ceramic cartridges should ever need to be removed for cleaning or replacing, follow Steps 1A through 1C above.

➤ If the internal diverter **HK1-10** that operates the side spray should ever need to be removed for cleaning or replacement, call for assistance and copy of the diverter removal and installation instructions.

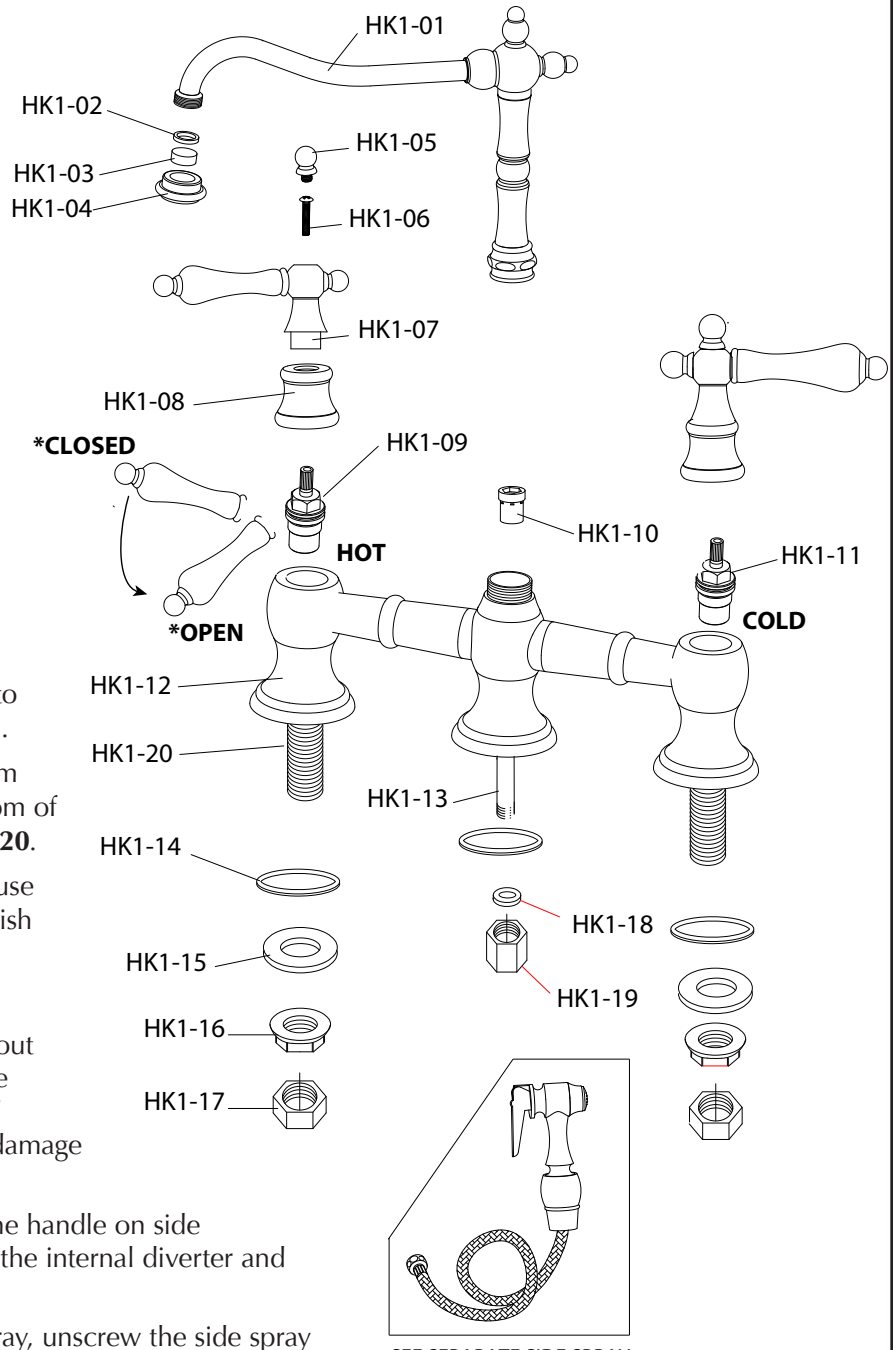

Giagni

for more information call

888.560.5222 FAX 888.560.8727 Monday - Friday 8:30am to 5:30pm EST

HK101

